

ATD

Anti-Tourniquet Designs

The patented designs which have been developed focus on secure windows, fixture and fittings such that:

1. Ligatures cannot be attached,
2. Any attempt to use the fittings for self-harm will result in the need to 'reset', so that such attempts are recorded,
3. The focus is primarily on the design aspect and ease of 'resetting' the fittings with the appropriate tool, however it would be possible to incorporate the use of a variety of materials such that a certain amount of 'give' will result in the fixture 'failing' in the event critical weight or pressure is applied.
4. Also, the designs to not allow for the fixtures to be dismantled in such a way that parts can be adapted for use as 'weapons' to inflict self-harm or harm to others.

The products type, visual and brief descriptions are listed below:

Door handles	<ul style="list-style-type: none"> • Room doors - operates for both hinged and sliding doors, • A tapered design that is secured to the ceiling or wall with tamper prove screws • If weight above a specified level is applied the hooks will 'fail' (this is achieved through the combined use of material used in the rail and the hook design). • With the appropriate tool the hooks can be readily reinserted into the railing.
Shower Curtain/ Clothes Rail	<ul style="list-style-type: none"> • A tapered design, secured to the ceiling with tamper prove screws • If weight above a specified level is applied the hooks will 'fail' (this is achieved through a combination of the material used in the rail and the hook design). • With the appropriate tool the curtain hooks can be readily reinserted into the railing.
Window Bars	<ul style="list-style-type: none"> • A unique tapering design that is strong enough to prevent forcing of the bars but does not allow for anything to be attached to the window.
Coat/Clothes Hook	<ul style="list-style-type: none"> • In the event weight is applied above a certain level, the hook will give, fold and lock into a recess. • The hook can be reset with the use of a simple tool.

ATD Anti-Tourniquet Designs

Door Handle

- Room doors - operates for both hinged and sliding doors
- All the handles taper downwards and angles get larger to stop wedging of ligatures

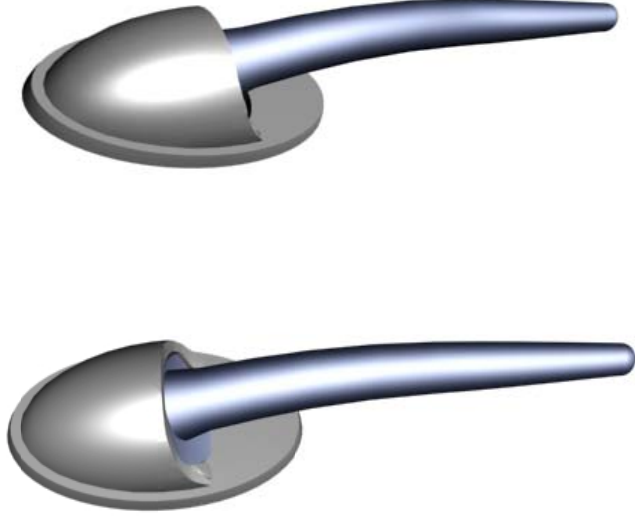

The cawling stops the handle being wedged in the horizontal position. Preventing any possible attachment point



ATD Anti-Tourniquet Designs

Curtain Rail

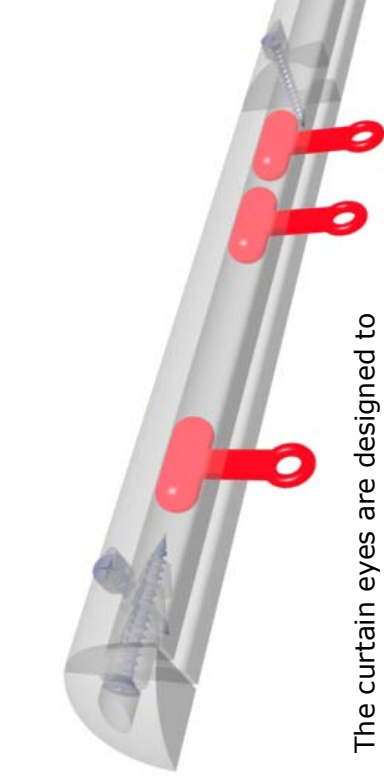
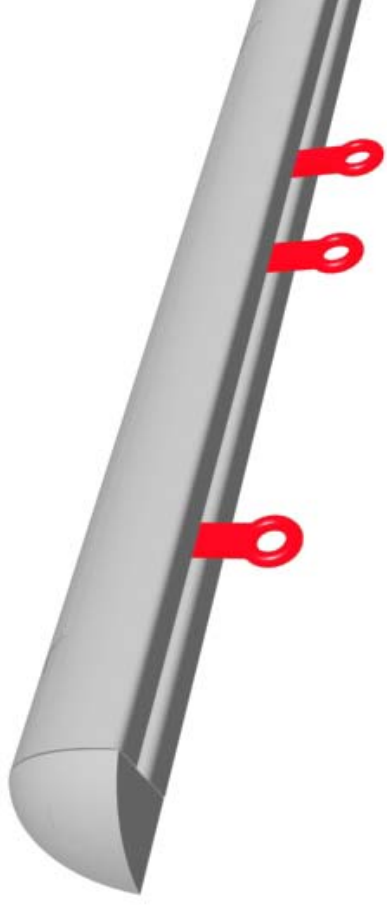

The curtain eyes are designed to break under load or pull out of the curtain track

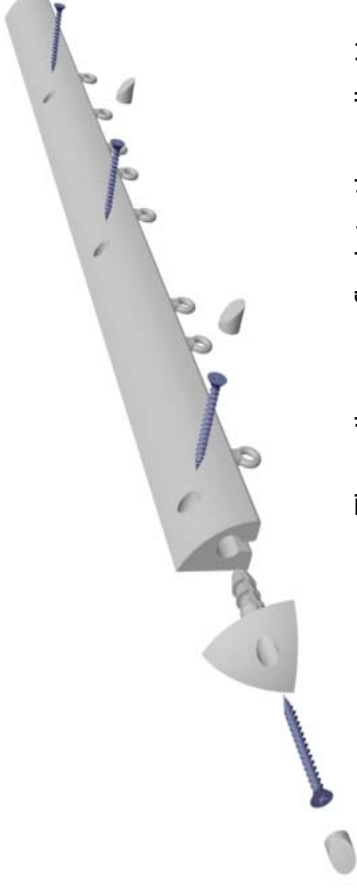

The rail screws flush to the wall. Varying thickness of rails can easily be made for different locations

ATD Anti-Tourniquet Designs

Shower Rail/ Clothes Rail

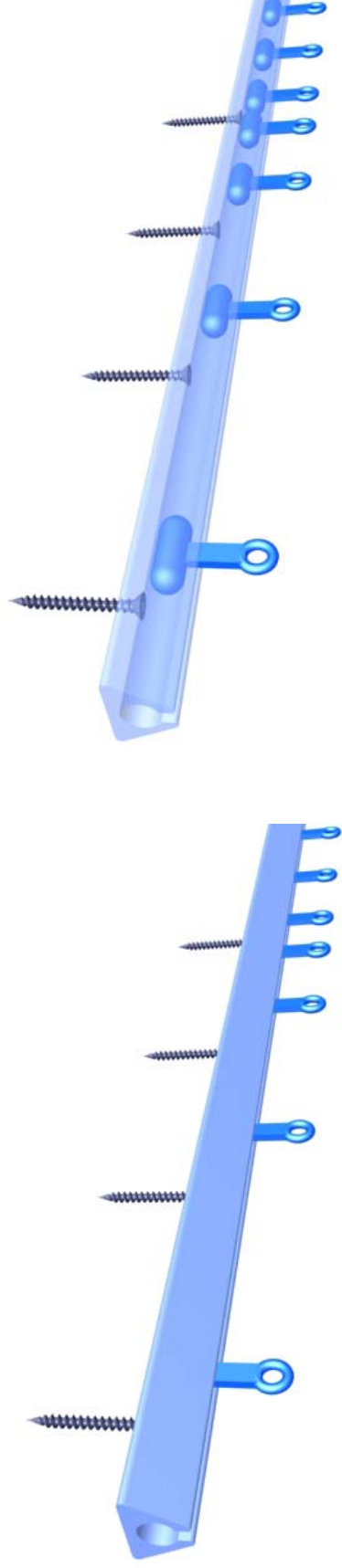

The rail screws flush to the bathroom ceiling or inside of a wardrobe.
Eyes can be used for either shower curtains or coat hangers

ATD Anti-Tourniquet Designs

Window Bars

- A unique tapering design that is strong enough to prevent forcing of the bars but does not allow for anything to be attached to the window.

Side view



ATD Anti-Tourniquet Designs

Front View



ATD Anti-Tourniquet Designs

Coat/Clothes Hook

- In the event weight is applied above a certain level the hook will give and fold into a recess, the hook locks in the down position to give visual indication that an attempt at harm has been made.
- The hook can be reset with the use of a simple tool.

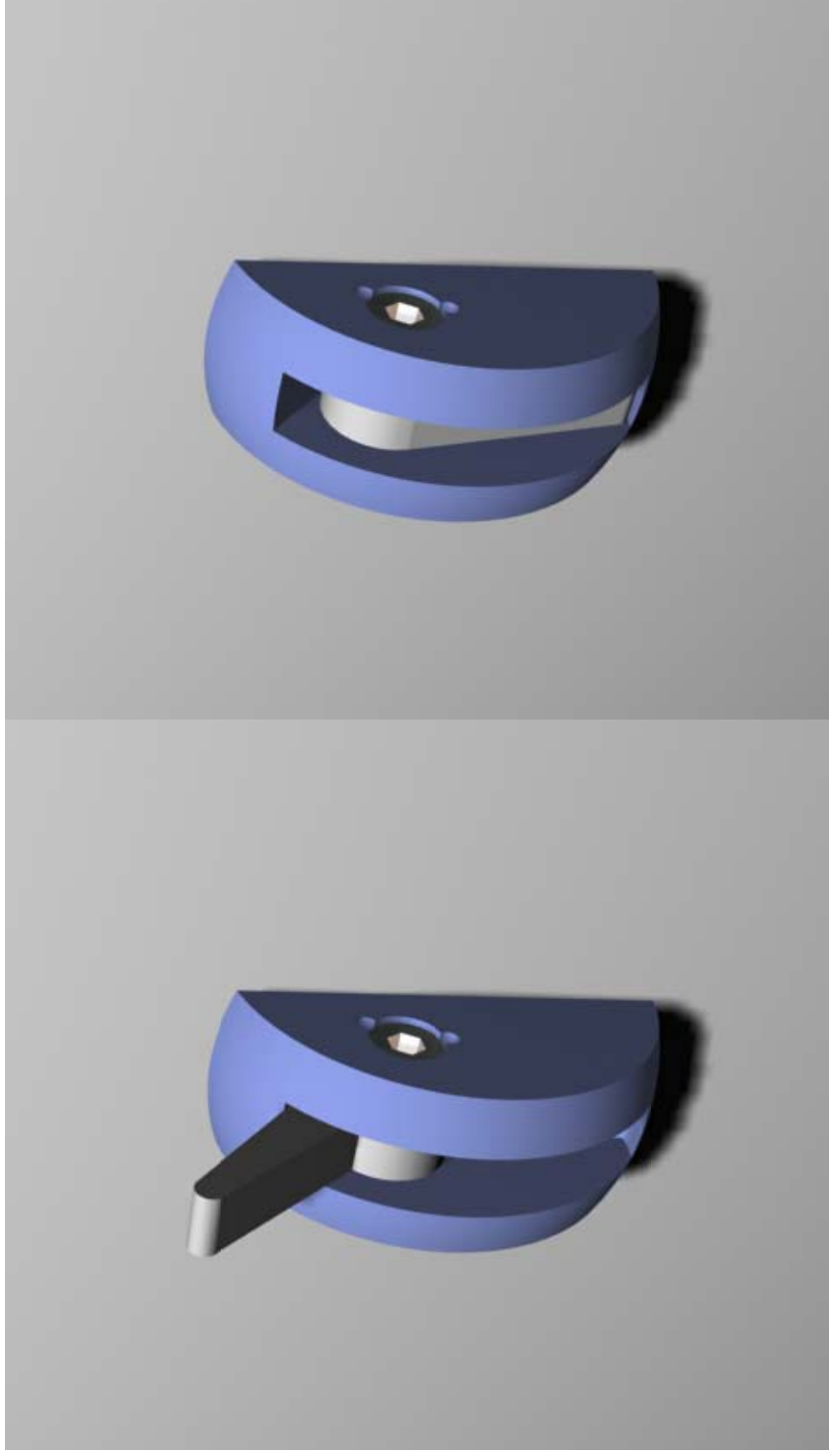

ATD Anti-Tourniquet Designs

Coat/Clothes Hook – exploded

